

dwell

At Home in the Modern World

Studio Visit
The Designer Remaking
Durham, North Carolina

Petal Power
A Flower-Shaped House
Blooms in the Berkshires

Make It Work

Upgrade Your Home Office

dwell.com

January / February 2021
Display until March 15, 2021

Isaac Resnikoff of
L.A. design collective
Project Room and his
son, Eli, arrive at their
Highland Park house,
which is finished with
simple materials and
filled with vintage finds.



the backyard house

TEXT BY Alex Temblador PHOTOS BY | @PARRISHUIZDEVELASCO Parrish Ruiz de Velasco

Rather than expand their midcentury home, Anthony Marks and his partner built a guesthouse on the unused half of their double lot, in Denton, Texas. The gated fence borrows from the material palette used for the dwelling. "It's like an introduction, or preview, to what lies beyond," says architect Michael Gooden.



Welcoming Addition

An ADU creates room for guests next to a historic 20th-century Texas home.

dwell+



Subscribe to Dwell+ to get everything you already love about Dwell, plus exclusive home tours, video features, how-to guides, access to the Dwell archive, and more.

Try Dwell+ for free at dwell.com/subscribe



On a recent evening in Denton, Texas, Anthony Marks and his partner placed a projector and screen in front of the new 672-square-foot guesthouse in their backyard. A dozen or so people spread around the adjacent pool deck and watched *Young Frankenstein* against the backdrop of the boxy, broad-roofed structure.

It wasn't the large unveiling party the couple had planned prior to the pandemic, but the accessory dwelling unit (ADU) was indeed designed with company in mind. Anthony and his partner live in a modern limestone and redwood house built in the late 1940s by local design luminaries Ray Gough and Roland Laney. But since the house has only two bedrooms—one of which is used as an office—their frequent weekend guests were often subjected to an air mattress.

"At first, we considered simply adding on to the main house," says Anthony, "but given its history and local significance, we decided to honor its architectural integrity and build a guesthouse instead."

The couple hired architect Michael Gooden, a Denton native and principal of M Gooden Design, for the project. The idea was to build a patio, a pool, and the >

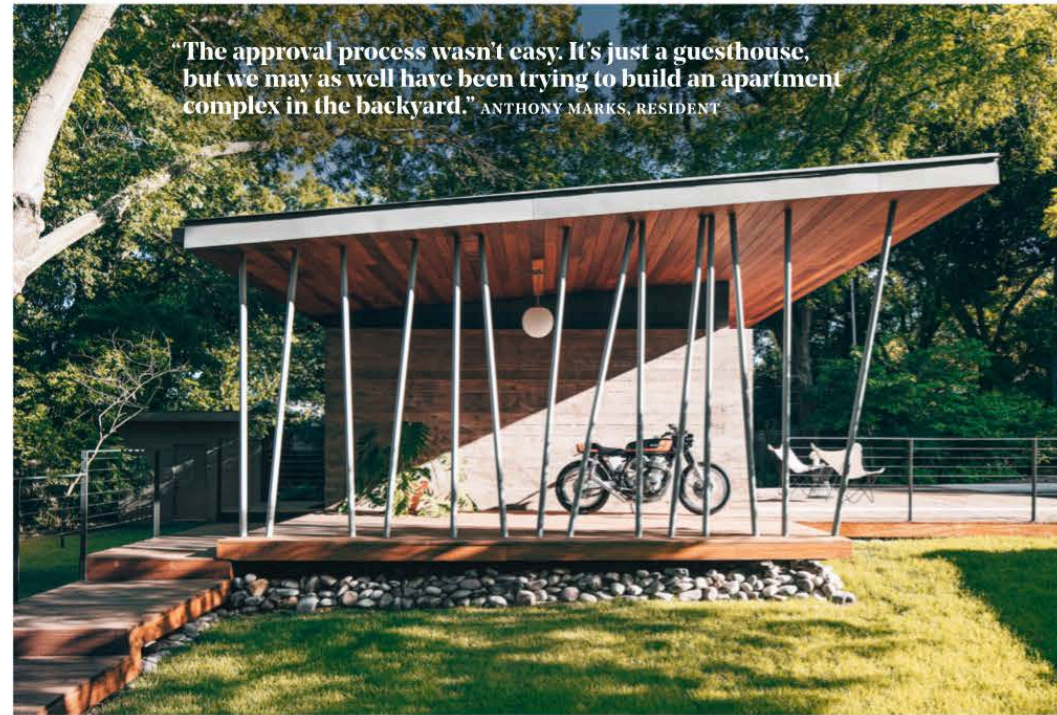
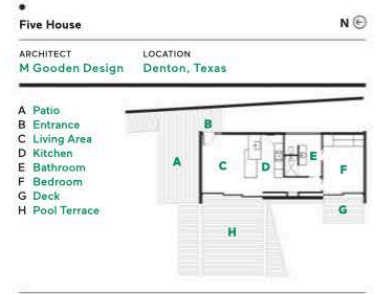

ILLUSTRATION: LOMNES + WRIGHT

Walls of board-formed concrete are warmed by the cumaru wood ceilings and decks (opposite, top). A red Womb chair from Knoll

adds a bright touch to the otherwise neutral palette (opposite, bottom). In the kitchen, Eames chairs flank a custom dining table,

and the pendant is by Wever & Ducré (above). The side patio doubles as a parking spot for a custom-built 1970 Honda CB750 (below).



the backyard house

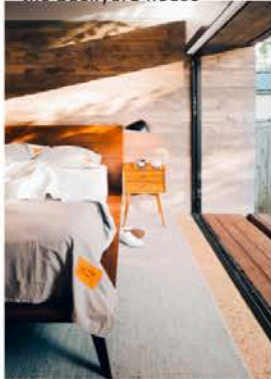

The bedroom furniture is from West Elm and the duvet is from Virgil Abloh's Markerad collection for IKEA. Acapulco chairs sit on the adjacent deck (below). The windows are by Milgard and the glass sliders are by Western Window Systems.

ADU on a five-foot planning grid (hence the name, Five House) that complemented their main home.

"We wanted to pay homage to the house, but not copy it exactly," says Anthony. Gooden, who worked with project architect Kevan Russell, describes the design as "a reinterpretation of how the original architects might have approached the new build seventy years later."

Passing through the ADU's private gate, you're first struck by the large sloping roof, with its five-foot cantilevered extension on the west side, facing the pool. A series of angled metal columns then draws your eye down to the large side patio, covered by another overhang. "There is an arrival sequence and approach to the unit that gives guests a sense of anticipation, delivering an expression of architecture that is both familiar and unique," says Gooden.

Five House also appears to float above

the ground, a result of the foundation's being placed on a five-foot incline that runs east to west. River rocks around the dwelling's perimeter add to this effect, while tall trees and a luxuriant landscape heighten the sense of its being suspended in nature.

Inside the structure, wood finishes pop against black elements like the kitchen backsplash, lighting fixtures, and dining table, while tapered furniture legs, a platform bed, and geometric pendants maintain an updated midcentury theme.

Since its completion last spring, Five House has allowed the couple to host overnight guests at a safe remove, and it has been the centerpiece of a few socially distant backyard gatherings. "Eventually, when the pandemic is over—and it will be, someday, right?—we hope to use Five House as a way to bring family, friends, and neighbors together as often as we can," says Anthony. ■



"The pitched ceilings and ribbon of clerestory windows make the interior feel more spacious than it is." MICHAEL GOODEN, ARCHITECT



modern market

Smart Shopping For the Design Obsessed. Find what you love in our expertly curated selection of finely crafted home, office, travel, and lifestyle products.

[More at Dwell.com/Shop](https://www.dwell.com/Shop)



Sonoma Forge
Sonoma Forge Exposed Showers

Nothing has the iconic look and feel of Sonoma Forge more than our WaterBridge Exposed showers. They're turning up everywhere, indoors and outdoors, in lush homes and at luxury resorts around the world. These are the thermostatic, set-it-and-forget-it, wall-mount models, also available as floor-mount. There are corresponding pressure-balanced models for a total of 16 to choose from. To make your shower perfect for you, there are options for the shower head, the handles, and the foot wash. Choose from Rustic Nickel (shown) Satin Nickel, Rustic Copper, Oil-Rubbed Bronze, and our new Matte Black. Forged in America.

www.sonomaforge.com
info@sonomaforge.com
(800) 330-5553



Otrio
Inventor's Edition

Enjoy Sweden & Finland's Family Game of the Year beautifully finished in solid walnut with anodized aluminum rings.

otrio.com



Kül Grilles
Modern Grilles for the Modern Home

Quality floor and wall grilles available in standard and custom sizes. See our gallery and architectural finish options online! Discount: dwell0121

kulgrilles.com



Box Design USA

Create curb appeal for your home or office! We have a wide range of letterbox solutions to fit your style. We are the North American distributor for these one-of-a-kind New Zealand designed mailboxes. We ship throughout the US and Canada.

Order online @ www.fos-design.com
customerservice@fos-design.com